

Laguna Beach  
Top of the World  
Damage to Open Space  
January 2024

# Road Building in Protective Open Space

Janine Robinson  
Photos of Road  
Grading Near Aliso  
& Wood Canyons  
Wilderness Park

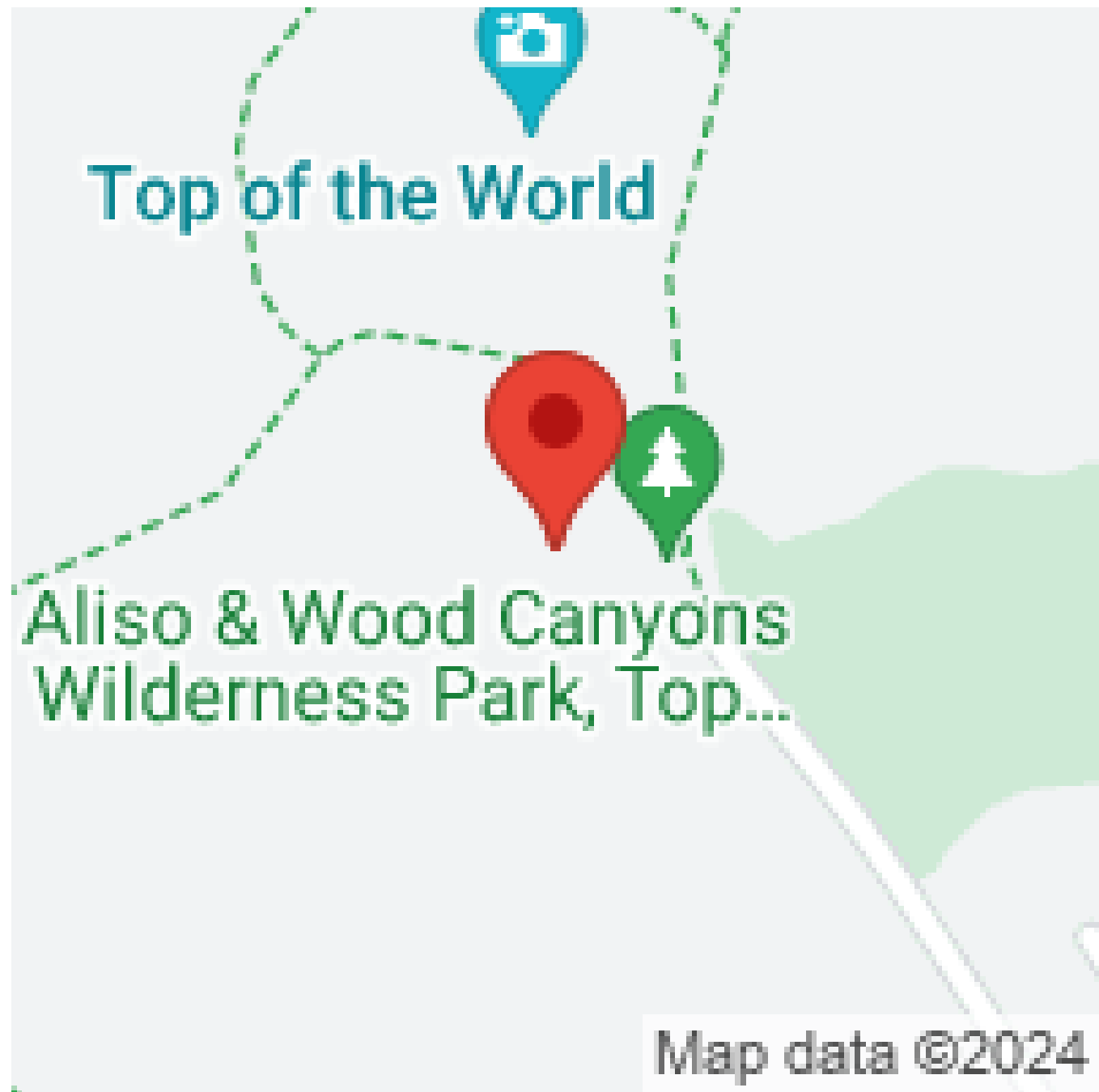









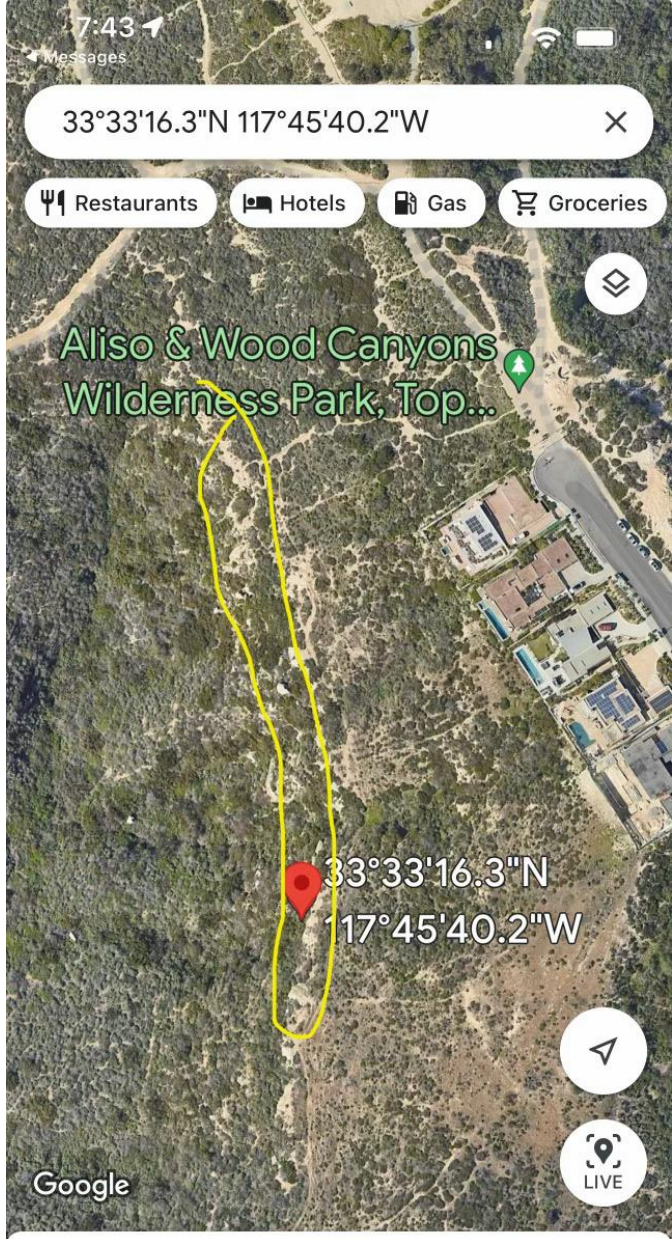

33°33'16.3"N 117°45'40.2"W

- Directions
- Start
- Save
- Add











# Graffiti in Protective Open Space













Handwritten Arabic calligraphy in blue paint, including the words "مكة" (Mecca) and "الحج" (Hajj).

Handwritten signature in red paint, appearing to be "S.M.S."



# Conditions of Approval of Tract 10054 Map

## Protective Open Space



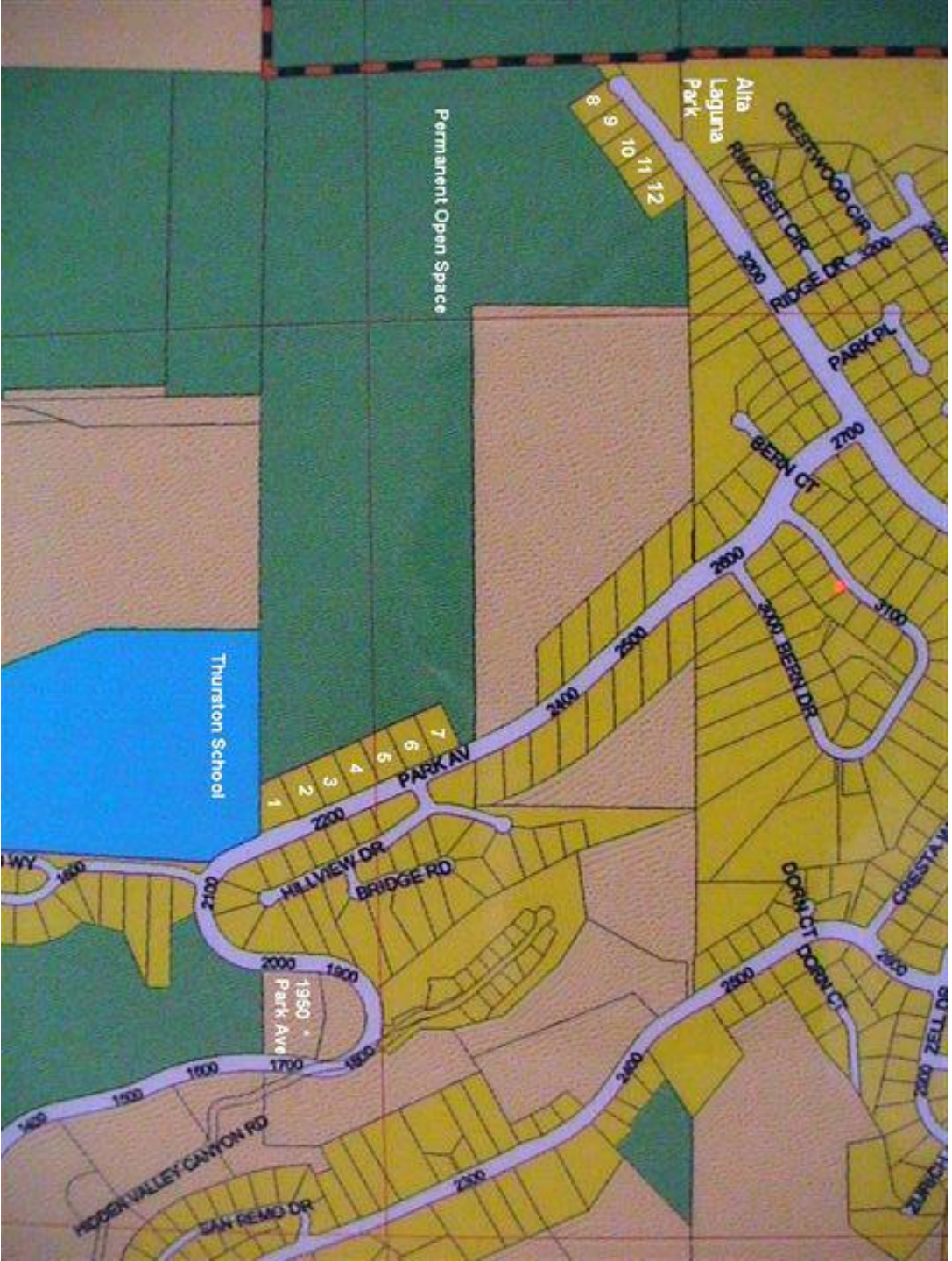

# RESOLUTION NO. 82.14

## Tract Map 10054 March 2, 1982

“Approving Tentative Tract 10054 for the subdivision of approximately 47 acres into 12 residential lots and two commonly owned open space lots in the R-1 zone for vacant land located between Alta Laguna Blvd. and Thurston Intermediate School, generally northwesterly and southeasterly of Park Avenue below Bern Drive”

“Ownership of Lot A shall allow public access with the development rights (open space easement) for the remainder parcels dedicated to the City in perpetuity.”

“Physical barriers shall be provided for the purpose of effectively prohibiting access to Lots A, B and C by unauthorized motor vehicles.”